

100
0 10
A1

DO NOT SCALE

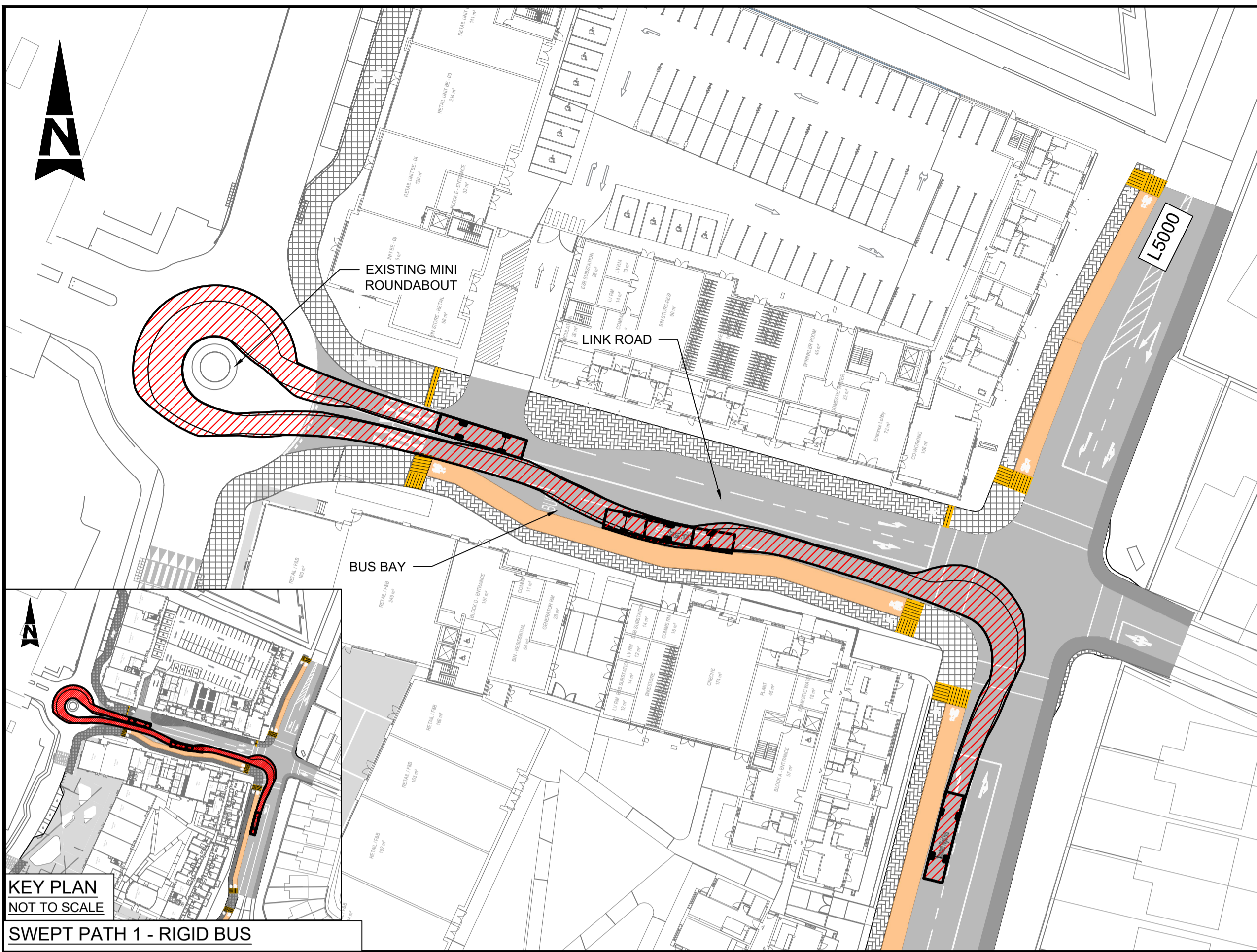

KEY PLAN
NOT TO SCALE
SWEPT PATH 1 - RIGID BUS

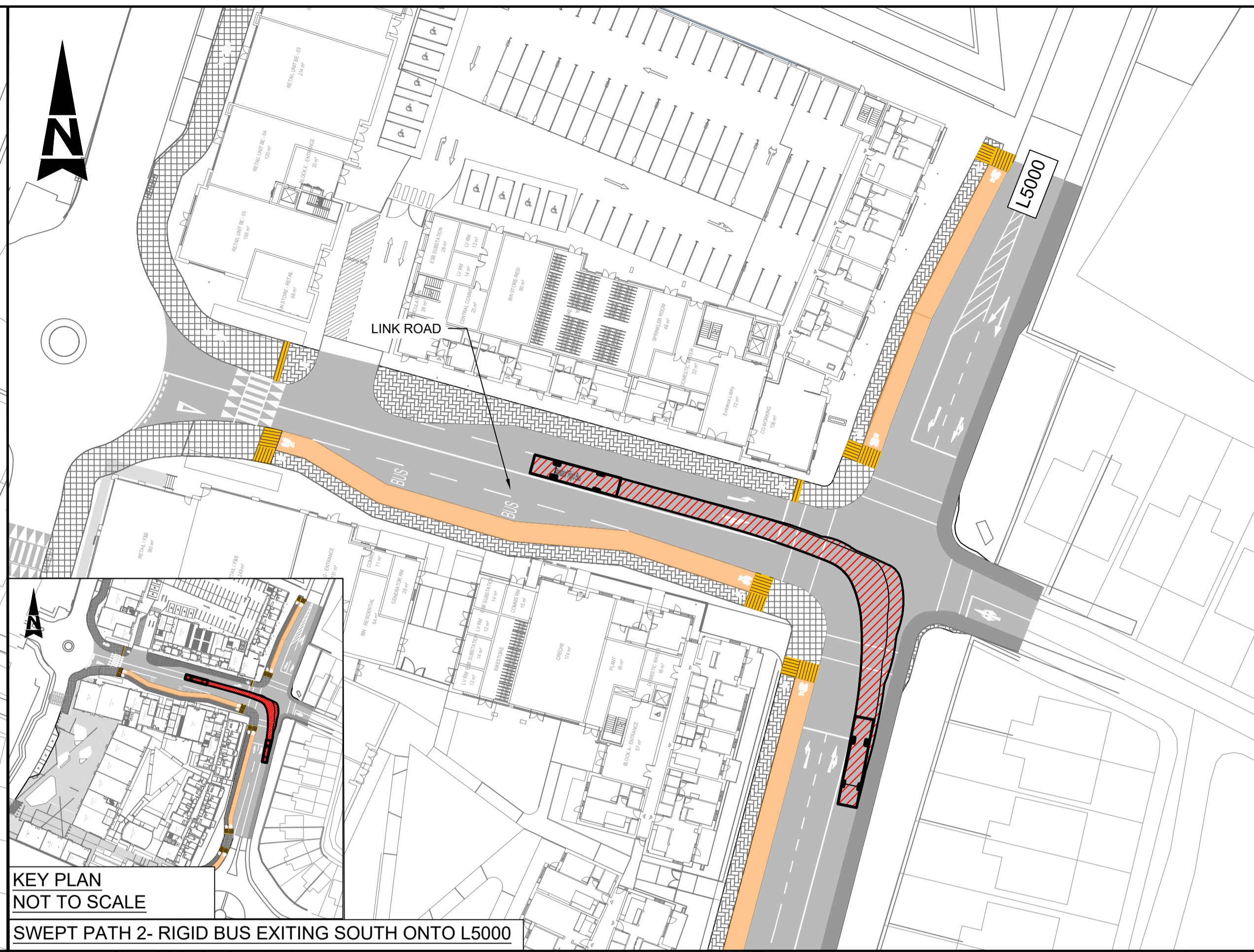

KEY PLAN
NOT TO SCALE
SWEPT PATH 2 - RIGID BUS EXITING SOUTH ONTO L5000

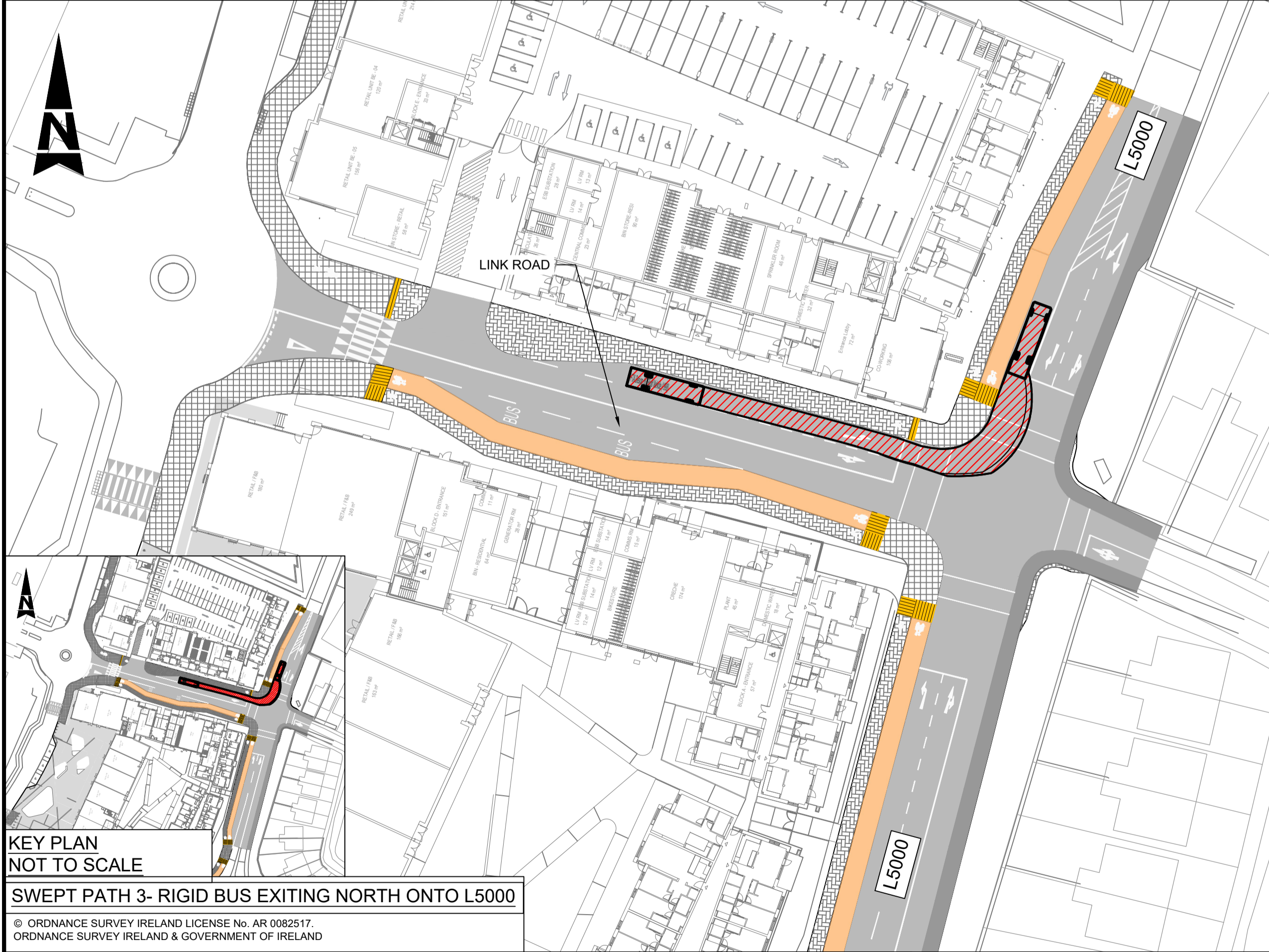

KEY PLAN
NOT TO SCALE
SWEPT PATH 3 - RIGID BUS EXITING NORTH ONTO L5000

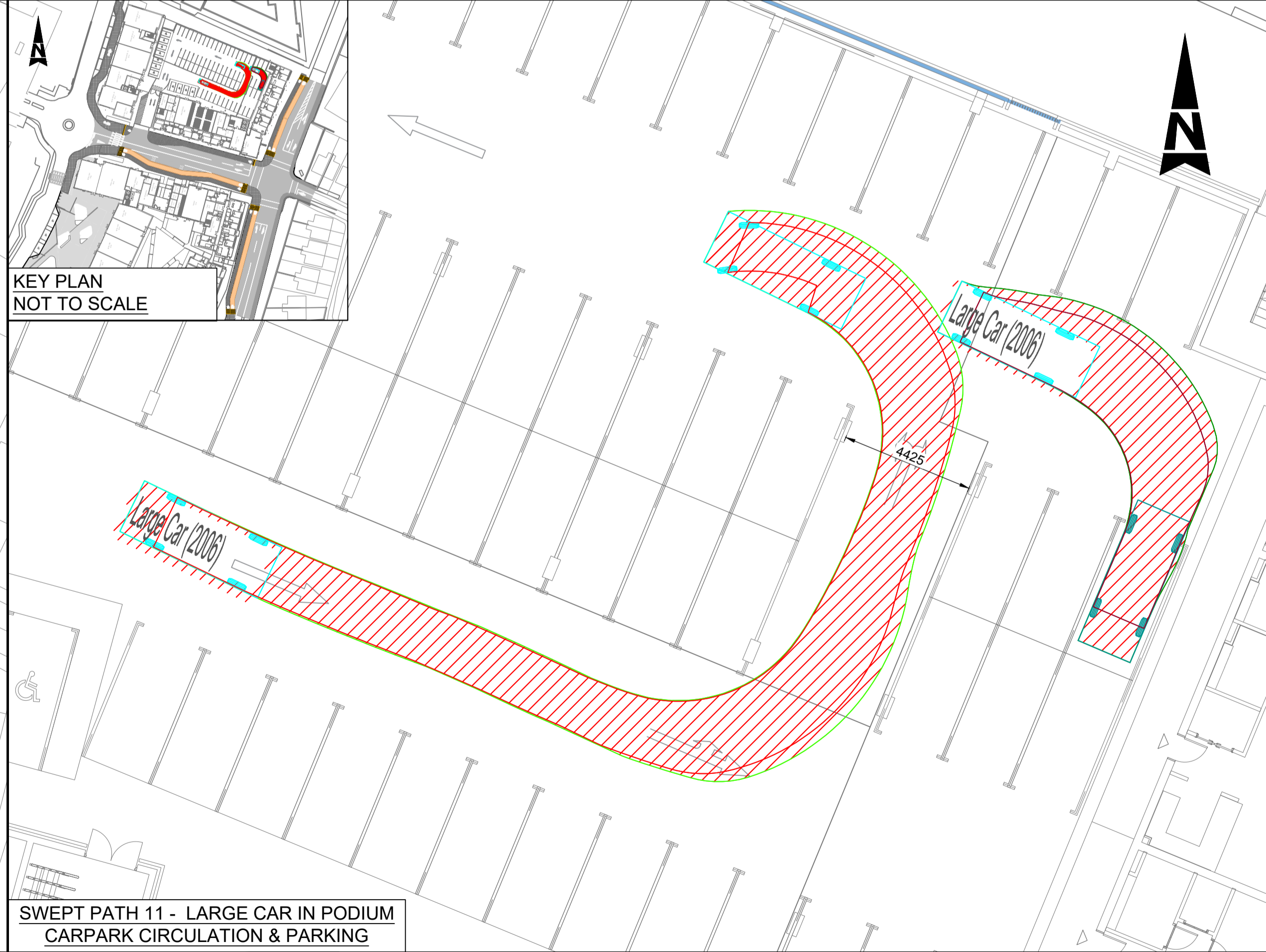

KEY PLAN
NOT TO SCALE
SWEPT PATH 11 - LARGE CAR IN PODIUM
CARPARK CIRCULATION & PARKING

- GENERAL NOTES**
1. ALL DIMENSIONS ARE IN METRES UNLESS NOTED OTHERWISE
 2. ONLY WRITTEN DIMENSIONS SHALL BE USED. NO DIMENSIONS SHALL BE SCALED FROM THE DRAWINGS
 3. ALL LEVELS ARE IN METRES AND ARE TO MALIN HEAD DATUM
 4. ALL COORDINATES ARE IN METRES AND ARE TO IRISH TRANSVERSE MERCATOR
 5. DRAWINGS ARE TO BE READ IN CONJUNCTION WITH THE SPECIFICATION
 6. POSITIONS OF EXISTING UTILITIES ARE BASED ON RECORDS FROM UTILITY COMPANIES WHERE AVAILABLE. THESE ARE SHOWN FOR BACKGROUND INFORMATION ONLY.
 7. ALWAYS REFER TO UTILITY RECORDS PACK AND VERIFY POSITIONS OF ASSETS ON SITE PRIOR TO COMMENCING ANY EXCAVATIONS.

VEHICLE PROFILES

DELIVERY TRUCK

FTA Design HG Rigid Vehicle

Overall Length	10.000m
Overall Width	2.500m
Overall Body Height	3.645m
Min Body Ground Clearance	0.440m
Track Width	2.470m
Lock-to-lock time	3.00s
Curb to Curb Turning Radius	11.000m

PASSANGER CAR

Overall length	5.079m
Overall width	1.872m
Overall body height	1.525m
Min body ground clearance	0.310m
Max track width	1.831m
Lock-to-lock time	4.00s
Curb to curb turning radius	5.900m

PUBLIC TRANSPORT BUS

'Standard' Rigid Bus

Overall Length	12.000m
Overall Width	2.550m
Overall Body Height	3.069m
Min Body Ground Clearance	0.309m
Track Width	2.350m
Lock-to-lock time	4.00s
Wall to Wall Turning Radius	10.771m

File: 5168265-ATK-HT-SK-1009.DWG
Date: Oct 30, 2019 - 12:24pm
Plotted by: Akonkoluiser

© ORDNANCE SURVEY IRELAND LICENSE No. AR 0082517.
ORDNANCE SURVEY IRELAND & GOVERNMENT OF IRELAND

Rev	Description	By	Date	Chk'd	Auth
A	ISSUED FOR INFORMATION	YC	02.10.19	KG	KG
-	ISSUED FOR INFORMATION	RG	14.05.19	AN	KG

ATKINS
Member of the SNC-Lavalin Group

Atkins House, 150-155 Airside Business Park, Swords, Co. Dublin
Tel (+353) 01 810 8000 Fax (+353) 01 810 8001

Unit 2B, 2200 Cork Airport Business Park, Cork
Tel (+353) 021 429 0300 Fax (+353) 021 429 0360

2nd Floor Technology House Parkmore Technology Park, Galway
Tel (+353) 091 786 0550 Fax (+353) 091 779 830

Client: **Glenveagh Living**

Project: **KNOCKNACARRA DISTRICT CENTRE**

Purpose: **STAGE 3 SUBMISSION**

Title: **VEHICULAR TRACKING SHEET 1 OF 3**

Original Scale	Design/Drawn	Checked	Authorised
Not To Scale	YC	AN	KG
Date	Date	Date	Date
19.03.19	19.03.19	19.03.19	19.03.19
Status	Drawing Number	Rev	
I	5168265 / ATK / SK / 1009	A	